

ACCOUNTING vs SCIENTIFIC
STAFFING MODEL

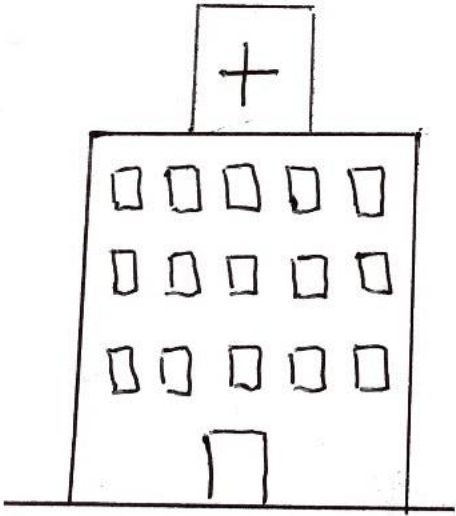

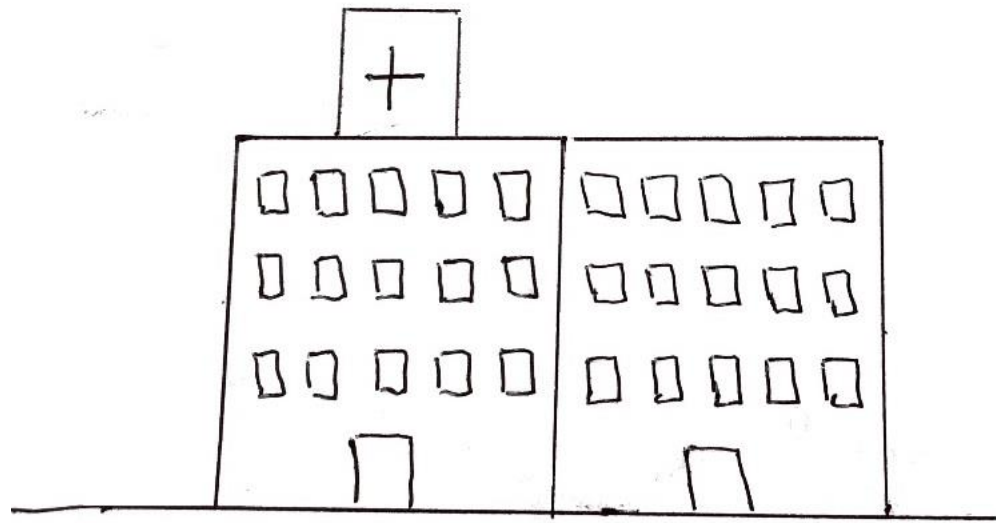

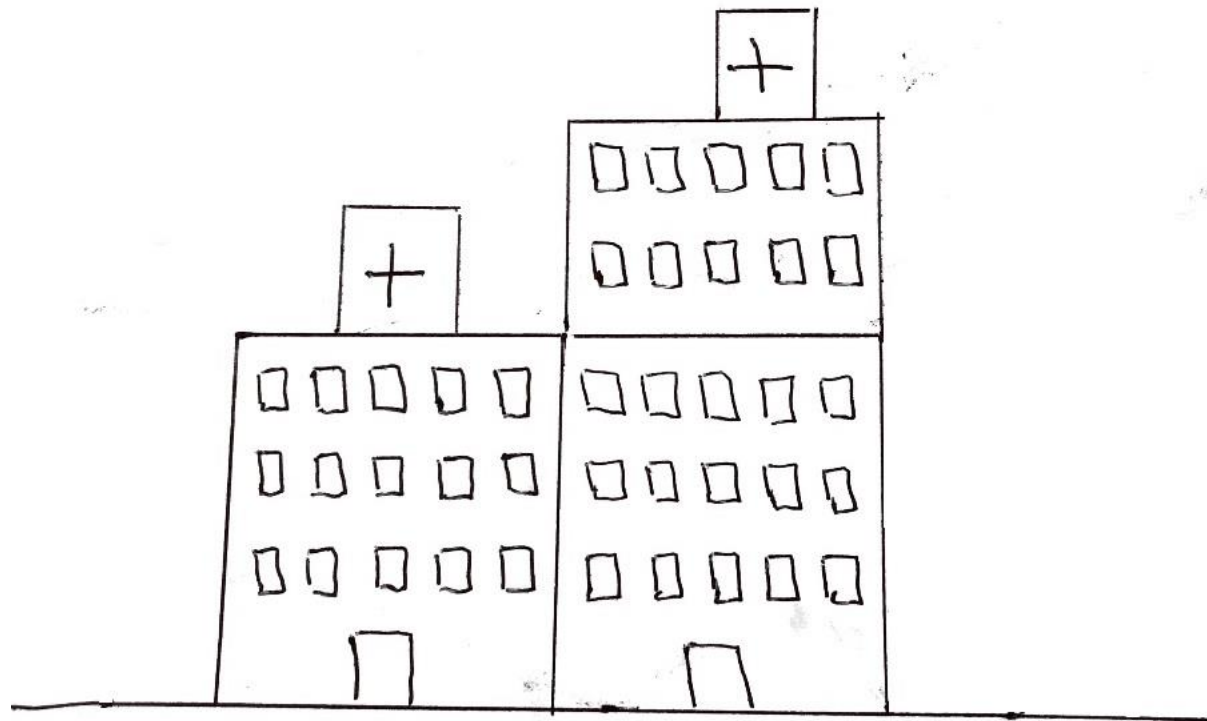

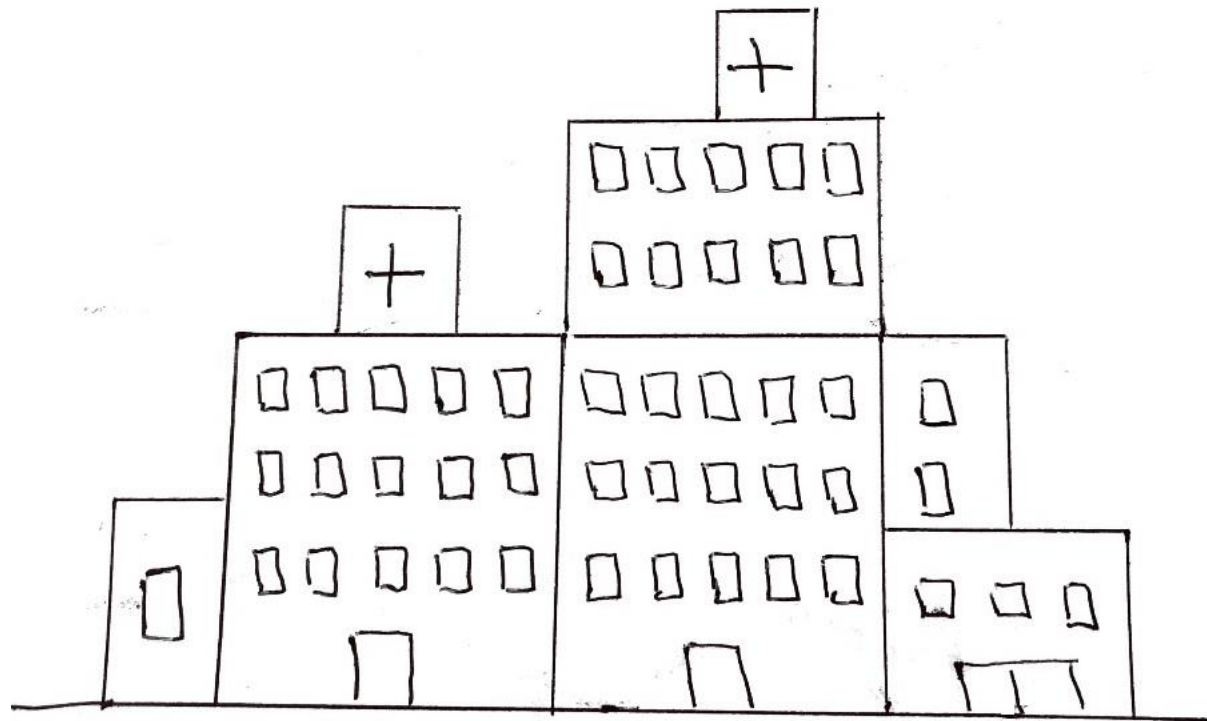

PREVIOUS | CURRENT | FUTURE

PREVIOUS | CURRENT | FUTURE



PREVIOUS

CURRENT

FUTURE

$$\frac{\text{BED DAYS}}{\text{TECH HEADS}} = x$$

HOSPITAL 1 =

HOSPITAL 2 =

HOSPITAL 3 =

HOSPITAL 4 =

$$\frac{\text{LICENSED BEDS}}{\text{TECH HEADS}} = y$$

$$\frac{\text{LICENSED BEDS}}{\text{TECH HEADS}} \times \frac{\text{TOTAL REMUNERATION}}{\text{TECH HEADS}} = z$$

PREVIOUS

CURRENT

FUTURE



PREVIOUS | CURRENT | FUTURE

$$RS = \left(\frac{A \cdot \sum w}{T \cdot S} \right) \cdot f$$

PREVIOUS

CURRENT

FUTURE

WORK ORDER #52318

ASSET: TV

NUMBER: 41782

PROBLEM: DOES NOT TURN ON

WORK PERFORMED

TIME USED: _____

TECHNICIAN: _____

PREVIOUS

CURRENT

FUTURE

FIRST SCIENTIFIC MODELS

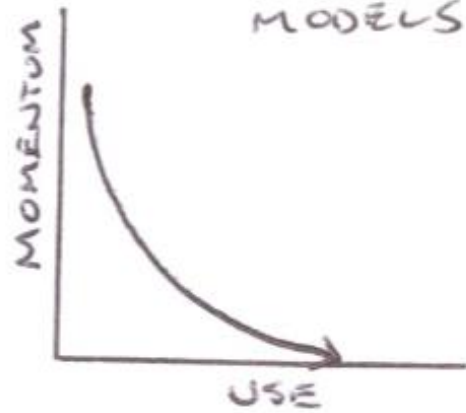

CURRENT SCIENTIFIC MODEL

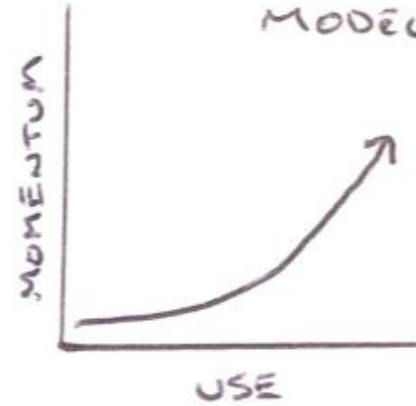

PREVIOUS

CURRENT

FUTURE

QTY
WORK
ORDERS

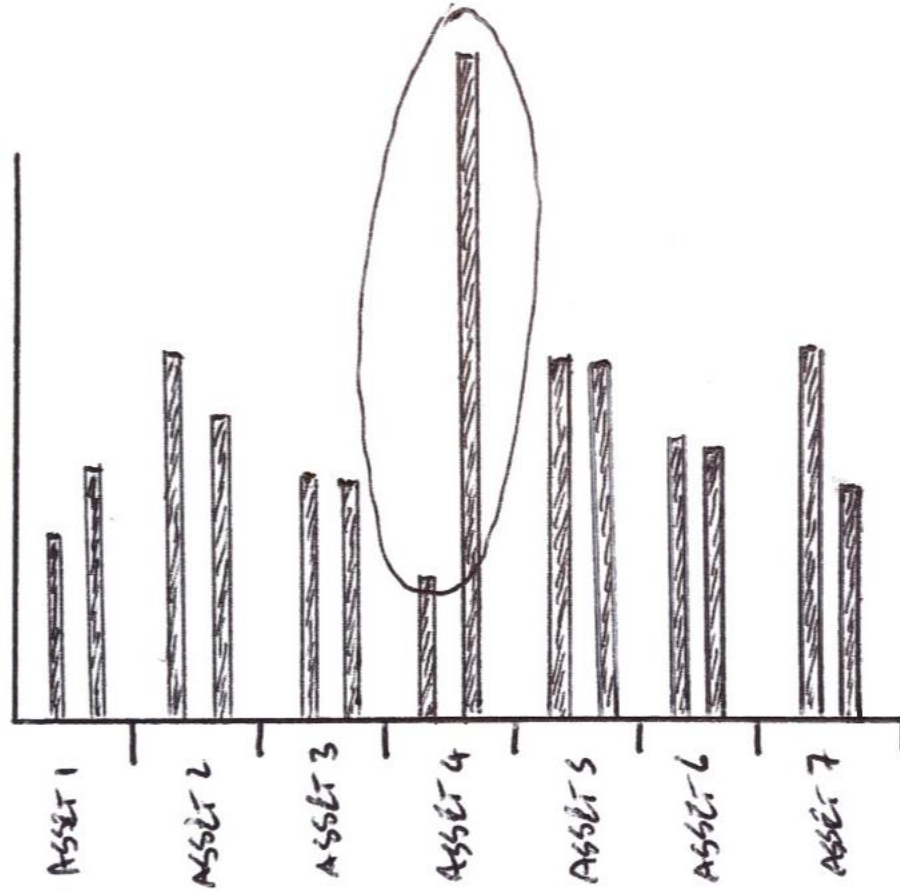

PREVIOUS

CURRENT

FUTURE

ACCURACY OF DATA



ASSET MANAGEMENT

MODEL INTEGRATION

THANK YOU